



### Deactivated Wool

Further improving our proprietary deactivation process, we make this deactivated wool more inert than our traditional fused silica wool, yet it is as flexible as our traditional borosilicate glass wool.

Description	qty.	cat.#
Deactivated Wool	10 grams	24324

### Base-Deactivated Wool

Ideal for amines and other basic compounds.

Description	qty.	cat.#
Base-Deactivated Wool	10 grams	20999

## tech tip

### Why Use Deactivated Wool for a Liner Packing?

- Ensure uniform vaporization in split or splitless liners.
- Prolong column life by trapping septum particles.
- Recommended for autosamplers with fast injection rates.



### Mini Wool Puller/Inserter

Insert and remove wool plugs easily. Order a spare pack so you'll always have one available.

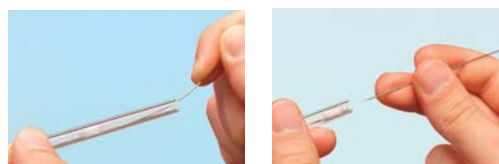

Description	qty.	cat.#
Mini Wool Puller/Inserter	2-pk.	20114

### Inlet Liner Packing Tool

- Position wool reproducibly every time.
- Accurate to a specific, measured depth.



Eliminates user variation!



Loosen the nut on the side of the tool and adjust the gauge to the manufacturer's recommended depth.



Place a plug of loosely bound wool at the top of the inlet liner.



Insert the liner packing tool into the liner until the tool bottoms out. Remove the tool. The wool is positioned correctly in the liner and the liner is ready for use.

Description	qty.	cat.#
Inlet Liner Packing Tool	ea.	20339

### Prepacked Inlet Liners

Let Restek do the work! Just add the appropriate suffix to the liner catalog number.

qty.	Wool	FS Beads	CarboFrit™†
ea.	-200.1	-201.1	-209.1
5-pk.	-200.5	-201.5	-209.5
25-pk.	-200.25	-201.25	-209.25

†CarboFrit™ inserts require a neck greater than 2mm.



**Sue Benes**

GC Accessories Product  
Marketing Manager

## tech tip

### Injector Maintenance

Approximately ninety percent of "bad" chromatography is traceable to problems in the injection port. These problems include contaminated carrier gas, incorrect injector flows, active or dirty sites on inlet seals and liners, improper use of wool, leaks, backflash, discrimination, incorrect injector temperature, poor column installation, and use of the wrong injection technique. To minimize injection port problems, set up a routine maintenance schedule and be sure to investigate the injector first when troubleshooting.