

Standard Electric Actuators



Two position standard electric actuators may be operated manually by a toggle switch or automatically by any data system with momentary contact closures or 5 VDC negative true logic outputs. A complete system, the actuator includes interface cable, power cord, and manual controller assembly with position indication.

Multiposition (selector) models work with any of our multiposition valves. The manual controller with LED display allows the user to step sequentially from one position to the next or to return to Position 1 (Home). A data system with momentary contact closures can direct the step and home functions; 5 VDC negative true logic outputs provide direct position access. A 20-conductor interface

cable permits the system to step the actuator sequentially, move the actuator directly to any position, and read the actual valve position.

Standard electric actuators can be ordered with closemount hardware, a standoff, or just the standoff mounting hardware, if your valve already has a standoff. Valves which will be mounted in ovens require a standoff assembly so that the actuator is located out of the heated zone.

The actuator's rotation (two position) or number of positions (multiposition) must be properly matched to the valve's. If you are converting a manual valve to electric actuation and have any doubts about which actuator and hardware you need, call our sales or technical staff for assistance.

ORDER TIP

To purchase a **valve with a standard electric actuator installed**, see valve ordering information.

Valco

Injectors and valves pp 102-116
Multiposition valves 122-133

Cheminert

Injectors and valves 152-167
Multiposition valves 170-177

TECH TIP

Valco two position W and UW type valves and Cheminert valves have the following angles of rotation:

3 port	90°
4 port	90°
6 port	60°
8 port	45°
10 port	36°
12 port	30°
14 port	26°

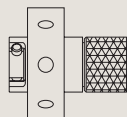

Valco

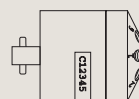

Cheminert

MORE INFORMATION Controllers

DVSP page 196
Digital valve sequence programmer
SVI 197
Serial valve interface

Mounting Hardware

Closemount hardware 208
Right angle drive . 204
Standoff assembly 205
Standoff mounting hardware 205

Standard electric actuators

for two position valves

Standard voltage: 110 VAC. (230 VAC and 24 volt CE versions optional. Consult factory for product numbers and pricing.)

Standoff version includes a 2" standoff. 3", 4", and 6" standoffs are also available.

No. of ports in valve	Description	With closemount assembly	With 2" standoff assembly	For use with existing standoff
		Prod No	Prod No	Prod No
3, 4	90° rotation	E90	E902	E90S
6	60° rotation	E60	E602	E60S
8	45° rotation	E45	E452	E45S
10	36° rotation	E36	E362	E36S
12	30° rotation	E30	E302	E30S

Standard electric actuators

for selectors

Standard voltage: 110 VAC. (230 VAC optional. Consult factory for product numbers and pricing.)

Standoff version includes a 2" standoff. 3", 4", and 6" standoffs are also available.

Description	With closemount assembly	With 2" standoff assembly	For use with existing standoff
	Prod No	Prod No	Prod No
4 position	E4	E42	E4S
4 x 2*	E4X2	E4X22	E4X2S
6 position	E6	E62	E6S
6 x 2**	E6X2	E6X22	E6X2S
8 position	E8	E82	E8S
10 position	E10	E102	E10S
12 position	E12	E122	E12S
16 position	E16	E162	E16S

* The 4 column selection valve, CST4UW, is an 8 position valve and needs a 4 x 2 actuator.

** The 6 column selection valve, CST6UW, is a 12 position valve and needs a 6 x 2 actuator.