

SANITARY FITTINGS



THE SF SERIES

SANITARY FITTINGS

SF Series sanitary fittings from Value Plastics are designed for use in single-use container fluid transport systems, manifolds and wherever sensitive fluids must be transferred. They are offered in two flange sizes, 1-1/2" ("Maxi") to comply with the ISO 2852 specification, and the popular 3/4" ("Mini") size commonly used with small tubing sizes. SF Series sanitary fittings incorporate 600 Series barbs for easy use with silicone, C-Flex® or Tygon® tubing.

Made from animal-free polypropylene

- No BSE documentation required
- Good chemical resistance
- Gamma stable to 50 kGy - Convenience

Radiused flow surfaces

- Smooth uninterrupted flow

No sharp edges in flow path

- Easy to clean

"Mini" and "Maxi" (ISO 2852) sizes

- Easy to retrofit to current components
- Works with commercially available clamps
- Industry accepted standard

Interior surface controlled to 15 micron Ra

- No particulate build-up

600 Series single barb

- Grips tubing securely
- Easy to install

Compatible with Barblock® tubing retainers

SFMN655 (-6005 - J1A)*

Sanitary Fitting, Mini Flange to 600 Series Barb, 1/4" (6.4 mm) Tubing ID



SFMN670 (-6005 - J1A)

Sanitary Fitting, Mini Flange to 600 Series Barb, 3/8" (9.5 mm) Tubing ID



SFMN680 (-6005 - J1A)

Sanitary Fitting, Mini Flange to 600 Series Barb, 1/2" (12.7 mm) Tubing ID

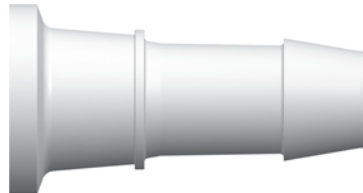

SFMN6100 (-6005 - J1A)*

Sanitary Fitting, Mini Flange to 600 Series Barb, 3/4" (19.0 mm) Tubing ID

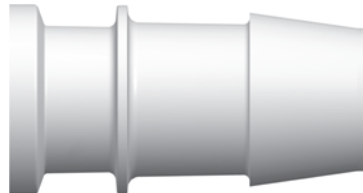

GMN450 (-PX)

Molded Gasket for "Mini" Flange



SFMNC (-6005)*

Sanitary Fitting Mini Cap



*Available in late 2008

Material Suffix Key

-6005 Animal-Free Natural Polypropylene

-J1A Natural PVDF

-PX Platinum-Cured Silicon

SFMX655 (-6005 - J1A)*

Sanitary Fitting, Maxi Flange to 600 Series Barb, 1/4" (6.4 mm) Tubing ID



SFMX6100 (-6005 - J1A)*

Sanitary Fitting, Mini Flange to 600 Series Barb, 3/4" (19.0 mm) Tubing ID

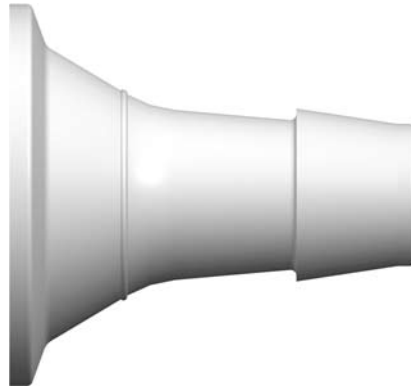

SFMX670 (-6005 - J1A)

Sanitary Fitting, Maxi Flange to 600 Series Barb, 3/8" (9.5 mm) Tubing ID



SFMX6110 (-6005 - J1A)*

Sanitary Fitting, Mini Flange to 600 Series Barb, 1.0" (25.4 mm) Tubing ID

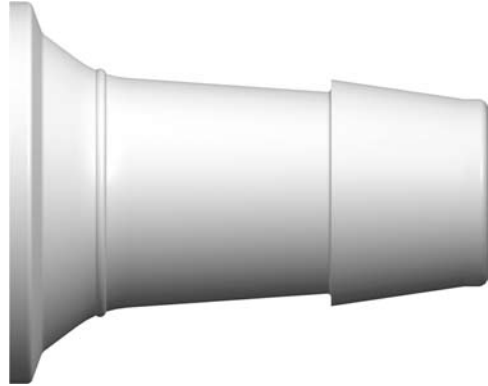

SFMX680 (-6005 - J1A)

Sanitary Fitting, Maxi Flange to 600 Series Barb, 1/2" (12.7 mm) Tubing ID

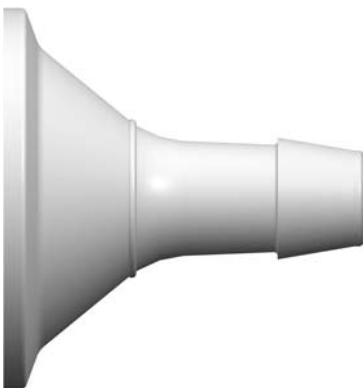

GMX455 (-PX)

Molded Gasket for "Maxi" Flange SFMX Series Fittings



SFMXC (-6005)*

Sanitary Fitting Maxi Cap



*Available in late 2008

SANITARY FITTINGS