



# Chromatography Columns & Accessories



**Inside.....**  
Specifications ..... 2  
Size Options and  
Bed Heights ..... 2  
Ordering Information ..... 3  
Accessories ..... 4

## Precision glass columns for low and mid-pressure liquid chromatography

- Pressure ratings to 1200 psi (80 bar)\*
- Solvent resistant
- Biocompatible
- Fixed or adjustable height
- Robust and easy to use

### Adjustable height

Up to 80 mm of height adjustment is possible with an adjustable endpiece (plunger). Our design gives the user fine control over the adjustment, minimizing the risk of disturbance to the packed bed. Whether you choose a fixed or adjustable height column, you will have the following options available:

### Standard aqueous system

Made from borosilicate glass and PTFE, and supplied with 25 µm polyethylene (PE) frits fitted, the columns are ready for use in the majority of applications.

### Solvent resistant system

Simply replacing the PE frit fitted in each endpiece, with the PTFE version supplied in the frit kit gives a totally inert system able to cope with the harshest laboratory chemicals

### Column tubing connections

All columns are supplied with a ready-assembled tubing set to connect into each end of the column. 1/4"-28 UNF fittings are supplied as standard and connect straight into the colored cap on each end of the column. Alternatively, M6 caps are supplied, enabling you to easily change the column over to an M6 fitting system.

### Replacement parts and accessories

Replacement glass columns, fixed endpieces, adjustable endpieces, frits and 'o'-rings are available separately. Accessories include frit tools, packing sleeves, column jackets, silicone seals, septum injectors and a bleed valve.

\* See page 2 for specific pressure ratings.

# Specifications

Series	006	
Wetted materials	Chromatographic tube:	Borosilicate glass
	Plunger:	PTFE
	Frit:	PTFE and PE
Connection options:	¼-28" UNF M6	
Frit options	Porosity:	5, 10, 25, 40, 70, or 100 µm
	Material:	PE and PTFE
Max pressure	3.0 mm bore:	1200 psi (80 bar)
	6.6 mm bore:	900 psi (60 bar)
	10 mm bore:	600 psi (40 bar)
	15 mm bore:	300 psi (20 bar)
	25, 35 and 50.0 mm bores:	150 psi (10 bar)

## Size Options and Bed Heights

Available Configuration (Orange)  
Not available (White)

		Column Length (mm)									Max Min	
		25	50	100	150	250	400	500	750	1000		
Bore (mm)	3	Endpiece Combination	25	50	100	150	250					
		2 fixed	25	50	100	150	250					
	6.6	2 fixed		20	70	120	220	370				
		1 fixed, 1 adjustable		20	70	120	220	370				
		2 adjustable		20	70	120	220	370				
		2 adjustable		20	70	120	220	370				
	10	2 fixed		20	70	120	220	370	470	720	970	
		1 fixed, 1 adjustable		20	70	120	220	370	470	720	970	
		2 adjustable		20	70	120	220	370	470	720	970	
		2 adjustable		20	70	120	220	370	470	720	970	
	15	2 fixed		20	70	120	220	370	470	720	970	
		1 fixed, 1 adjustable		20	70	120	220	370	470	720	970	
		2 adjustable		20	70	120	220	370	470	720	970	
		2 adjustable		20	70	120	220	370	470	720	970	
	25	2 fixed			70	120	220	370	470	720	970	
		1 fixed, 1 adjustable			70	120	220	370	470	720	970	
		2 adjustable			70	120	220	370	470	720	970	
		2 adjustable			70	120	220	370	470	720	970	
35	2 fixed			70	120	220	370	470	720	970		
	1 fixed, 1 adjustable			70	120	220	370	470	720	970		
	2 adjustable			70	120	220	370	470	720	970		
	2 adjustable			70	120	220	370	470	720	970		
50.5	2 fixed			70	120	220	370	470	720	970		
	1 fixed, 1 adjustable			70	120	220	370	470	720	970		
	2 adjustable			70	120	220	370	470	720	970		
	2 adjustable			70	120	220	370	470	720	970		

Achievable Bed Height (mm)

Bed height of 2.4 shown in table is the minimum and is when the two endpieces touch.

Adjustable endpieces provide 80mm of movement into the column.

Achievable bed heights are calculated with the endpieces in their standard configuration, i.e. with the Polyethylene frit fitted.

Minor changes in bed height may be experienced when frits other than the standard fitment Polyethylene type are retro-fitted.

### Each column assembly includes:

#### Assembled column

- 1 x precision-bore borosilicate glass column
- 1 x PTFE fixed endpiece with 25 µm PE frit OR adjustable endpiece
- 1 x PTFE fixed endpiece with 25 µm PE frit OR adjustable endpiece
- 2 x 1/4"-28 UNF endcaps

#### Frit kit

- 2 x 25 µm PTFE frits
- 2 x 10 µm PTFE frits
- 2 x 10 µm PE frits

#### Fittings kit

- 2m x 1/16" OD PTFE tubing with 1/4"-28 UNF fitting
- 0.5m x 1/16" OD PTFE tubing with 1/4"-28 UNF fitting
- 2 x M6 endcap

Note: 3.0 mm columns do not include a frit kit and use fixed endpieces only.  
Note 2: Frit kits are not included with 3 mm columns.

# Ordering Information

## Complete Column Assemblies

### Series

1	006	Chromatography Columns
---	-----	------------------------

### Part Type

2	CC	Complete Column
---	----	-----------------

### Bore Size

3	03	3.0 mm bore
	06	6.6 mm bore
	10	10 mm bore
	15	15 mm bore
	25	25 mm bore
	35	35 mm bore
	50	50 mm bore

### Length

4	02	25 mm
	05	50 mm
	10	100 mm
	15	150 mm
	25	250 mm
	40	400 mm
	50	500 mm
	75	750 mm
	100	1000 mm

### Endpiece Type

5	FF	Fixed / Fixed
	AF	Adjustable / Fixed
	AA	Adjustable / Adjustable

Note: 3.0 mm columns use fixed endpieces

Example P/N: 006 CC - 10 - 40 - AF  
 Series Part Bore Length Endpieces  
 Type Size

Part Number 006CC-10-40-AF consists of a 10 mm bore size, 400 mm length, one adjustable endpiece and one fixed endpiece.



## Replacement Parts

### Endpieces

1	Series	006 (Chromatography)
2	Part Type	FE (Fixed), AE (Adjustable)
3	Bore Size	03, 06, 10, 15, 25, 35 or 50

Note: 3 mm columns use fixed endpieces only

Example P/N: 006 FE - 35  
 Series Part Bore  
 Type Size

### Glass

1	Series	006 (Chromatography)
2	Part Type	RG (Replacement glass)
3	Bore Size	03, 06, 10, 15, 25, 35 or 50
4	Length	02, 05, 10, 15, 40, 50, 75 or 100

Example P/N: 006 RG - 06 - 50  
 Series Part Bore Length  
 Type Size

### Frits

1	Series	006 (Chromatography)
2	Part Type	FR (Frit)
3	Bore Size	06, 10, 15, 25, 35 or 50
4	Pore Size	5, 10, 25, 40, 70
5	Material	Leave blank for PTFE, PE (Polyethylene)

Note: Frits for 3.0 mm columns are not offered. A replacement endpiece must be purchased.

Example P/N: 006 FR - 15 - 25 - PE  
 Series Part Bore Pore Material  
 Type Size Size (Leave blank for PTFE)

### O'-rings

1	Series	006 (Chromatography)
2	Part Type	OR ('O' - Ring)
3	Bore Size	03, 06, 10, 15, 25, 35 or 50
4	Material	V (Viton), S (Silicone)

Example P/N: 006 OR - 25 - V  
 Series Part Bore Material  
 Type Size

# Accessories

## Packing Sleeves (column connecting sleeves)

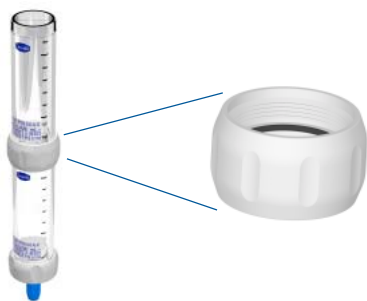

Part Number	Description
006PS-03	for 3.0mm bore sizes
006PS-06	for 6.6mm bore sizes
006PS-10	for 10mm bore sizes
006PS-15	for 15mm bore sizes
006PS-25	for 25mm bore sizes
006PS-35	for 35mm bore sizes
006PS-50	for 50mm bore sizes

## Column Jackets (for temperature control)



Part Number	Description
6331	100mm length for 3.0, 6.6, and 10mm bore sizes
6332	150mm length for 3.0, 6.6, and 10mm bore sizes
6333	200mm length for 3.0, 6.6, and 10mm bore sizes
6334	250mm length for 3.0, 6.6, and 10mm bore sizes
6342	150mm length for 15 and 25mm bore sizes
6343	250mm length for 15 and 25mm bore sizes

## Frit Insertion and Removal Tools



6770NS

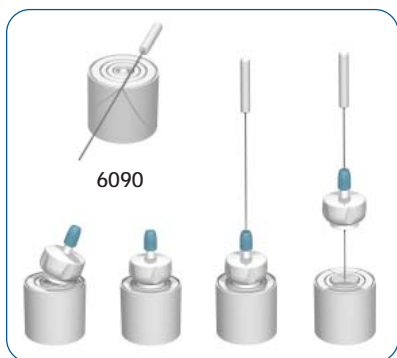

6090

Part Number	Description
6770NS	Insertion tool for 6.6mm bore sizes
6170	Insertion tool for 10mm bore sizes
6451	Insertion tool for 15mm bore sizes
6270	Insertion tool for 25mm bore sizes
6951	Insertion tool for 35mm bore sizes
6870	Insertion tool for 50mm bore sizes
6090	Frit removal tool

## Silicone Seals



Part Number	Description
6330SS1	for 3.0mm bore sizes
6330SS2	for 6.6mm bore sizes
6330SS3	for 10mm bore sizes
6342SS1	for 15mm bore sizes
6342SS2	for 25mm bore sizes
6951	for 35mm bore sizes

## Bleed Valve and Septum Injectors



1131



2508



3301

Part Number	Description
1131	Column bleed valve with one 1/4"-28 male and two 'Omnifit Cap' connections
2508	Septum injector with one 1/4"-28 male connection and one 'Omnifit Cap' connection
3301	Universal septum injector with two 'Omnifit Cap' connections

Bio-Chem Valve / Omnifit, 2 College Park, Coldhams Lane, Cambridge, CB1 3HD UK  
t: +44 (0) 1223 416642 f: +44 (0) 1223 416787 e: sales@omnifit.com w: omnifit.com

Bio-Chem Valve / Omnifit, 85 Fulton Street, Boonton, NJ 07005 USA  
t: 973 263 3001 f: 973 263 2880 e: info@bio-chemvalve.com w: bio-chemvalve.com