

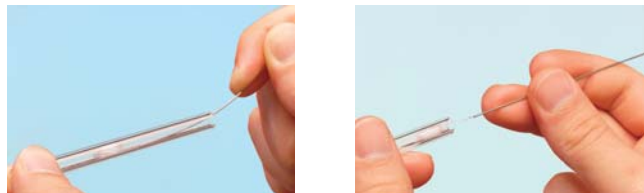

Mini Wool Puller/Inserter

Insert and remove wool plugs easily. Order a spare pack so you'll always have one available.



Description	qty.	cat.#	price
Mini Wool Puller/Inserter	2-pk.	20114	



Eliminates user variation!

Inlet Liner Packing Tool

- Position wool reproducibly every time.
- Accurate to a specific, measured depth.
- Can be used with all manufacturer's liners.

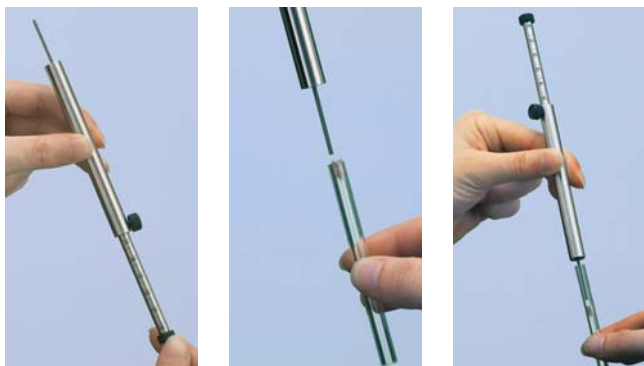

Loosen the nut on the side of the tool and adjust the gauge to the manufacturer's recommended depth.

Place a plug of loosely bound wool at the top of the inlet liner.

Insert the liner packing tool into the liner until the tool bottoms out. Remove the tool. The wool is positioned correctly in the liner and the liner is ready for use.

Description	qty.	cat.#	price
Inlet Liner Packing Tool	ea.	20339	



No more burned fingers!



Inlet Liner Removal Tool

- Easily remove liner from injector—no more burned fingers.
- Made from high-temperature silicone.
- Won't chip or crack the liner.

Description	qty.	cat.#	price
Inlet Liner Removal Tool	3-pk.	20181	



No more burned fingers!

The Claw and The Claw Holder Kit

- Easily removes hot liners from injection ports.
- 4mL vials (not included) can be replaced when dirty.

Never again will you have to burn your fingers removing a hot injection port liner. The Claw safely and cleanly removes liners, O-rings, or other small objects from the injection port. You can then place the hot objects in a clean 4 mL vial situated in the Claw holder until ready for reuse.



Description	qty.	cat.#	price
The Claw	ea.	26261	
The Claw Holder Kit (includes The Claw and holder)	kit	26262	
WISP 48 Snap Seal Vial	100-pk.	24658	

i tech tip

Injector Maintenance

Approximately ninety percent of "bad" chromatography is traceable to problems in the injection port. These problems include contaminated carrier gas, incorrect injector flows, active or dirty sites on inlet seals and liners, improper use of wool, leaks, backflash, discrimination, incorrect injector temperature, poor column installation, and use of the wrong injection technique. To minimize injection port problems, set up a routine maintenance schedule and be sure to investigate the injector first when troubleshooting.