

### VICI® Mat/Sen® Gas-Specific Purifier Modules

- Replace separate oxygen, moisture, and hydrocarbon traps with one multiple-bed purifier, specific for purifying helium, hydrogen, nitrogen, or air.
- Reduce gas impurities from ppm to low ppb levels.
- Decrease baseline noise and increase GC/MS sensitivity.
- Prepurged with the specified gas, to shorten downtime.

Performance for these purifiers is optimized by incorporating a multiple-bed format that progressively lowers concentrations of contaminants at each successive bed. VICI® Mat/Sen® purifiers are guaranteed to produce gases that are purer than 99.9999%, when supplied with gas of 99.995% purity, and are prepurged with the specified gas to speed conditioning. Purifier capacity is approximately four tanks of gas at 99.995% (50 ppm) purity, and correspondingly longer for purer gases.



Dimensions: 21" x 1 1/2"  
(53.3 x 3.8 cm)

Please Note: We recommend using an indicating oxygen trap (e.g., cat.# 22029, pg. 225) downstream from a VICI® Mat/Sen® purifier to continually ensure gas purity and indicate absolute change-out time.

#### Specifications:

Length	21" (53.3 cm)
Diameter	1.5" (3.8 cm)
Maximum Inlet Pressure	1,000 psi (6895 kPa)
Maximum Recommended Flow	500 mL/min.
Pressure Drop from 120 psi (827 kPa)	
inlet at at 0-500mL/min.:	<0.20 psi (1.4 kPa)
End Fittings	compression, 1/8" or 1/4", stainless steel
Shipping Weight	3.04 lb. (1,300 g)

#### Gas-Specific Purifier Module

	Compression Tube Fittings					
	1/4-inch			1/8-inch		
	qty.	cat.#	price	qty.	cat.#	price
Helium Purifier Module	ea.	22600		ea.	22601	
Hydrogen Purifier Module	ea.	22602		ea.	22603	
Nitrogen Purifier Module*	ea.	22604		ea.	22605	
Air Purifier Module	ea.	22606		ea.	22607	

\*Warning: Do not use with nitrogen containing more than 500 ppm of oxygen. If the oxygen level in the stream exceeds 500 ppm, use an air purifier.

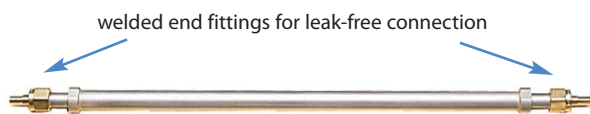

Dimensions: 13" x 1/2" (33 x 1.3 cm)

### Thermal Gas High Capacity Purifier Replacement Getter Tube

Each replacement getter tube has 12 L oxygen and 35 L water vapor capacity at a minimum flow rate of 1 liter/minute and removes oxygen, water, carbon monoxide, carbon dioxide, hydrocarbons (except methane) to ppb levels; pure enough for MS. Typically requires replacement once per year.

Change tube when gas pressure drops.

Replacement Getter Tubes	qty.	cat.#	price
1/8" Fittings (Similar to Supelco part# 2-2396)	ea.	21661	
1/4" Fittings (Similar to Supelco part# 2-2398)	ea.	21660	

Replacement getter tubes must be used with a Thermal Gas Purifier housing unit.

### Gas Pressure Gauge Kit

- Use an in-line pressure gauge to indicate when a thermal gas purifier getter tube should be replaced.
- Includes 1/8" tee and 0–100 psi (0-689 kPa) gauge.



Description	qty.	cat.#	price
In-line Gas Pressure Gauge Kit for Thermal Gas Purifiers	kit	21657	

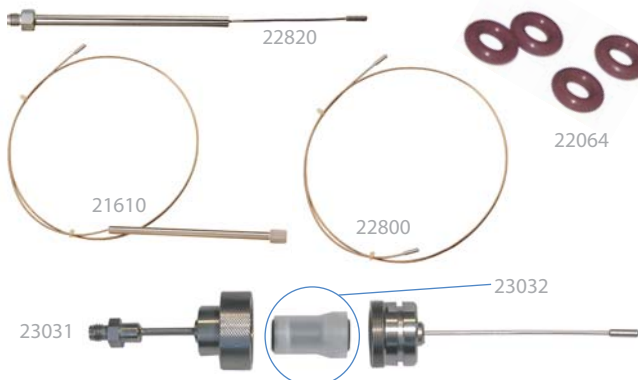

### Replacement Chemical Traps

- Easy to install.
- Attach to same fittings as original manufacturer's equipment.
- Built-in frits retain fine particles; adsorbents remove both moisture and hydrocarbons.

Description	Similar to Agilent part #	qty.	cat.#	price
Replacement Split Vent Trap for Agilent 6890/6850 GCs	G1544-80550	ea.	22820	
Replacement Chemical Trap for Agilent 5890 GCs	05890-61260	ea.	21610	
Split Vent Line (32-inch) for Agilent GCs				
Includes: all installation hardware	19251-80525	2-pk.	22800	
O-Rings for Agilent Trap Fittings	5180-4181	25-pk.	22064	
Optional Split Vent Trap Assembly for Agilent 6890/6850 GCs	G1544-60610	kit	23031	
Replacement Traps (2) and O-Rings (4)	G1544-80530	kit	23032	



Eliminate ghost peaks—change your chemical trap often!