

SFMX655 (-6005 -J1A)

Sanitary Fitting, Maxi Flange 1-1/2" to 600 Series Barb, 1/4" (6.4 mm) Tubing ID



SFMX6100 (-6005 -J1A)

Sanitary Fitting, Maxi Flange 1-1/2" to 600 Series Barb, 3/4" (19.0 mm) Tubing ID

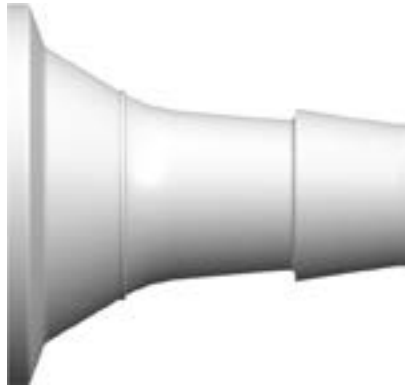

SFMX670 (-6005 -J1A)

Sanitary Fitting, Maxi Flange 1-1/2" to 600 Series Barb, 3/8" (9.5 mm) Tubing ID



SFMX6110 (-6005 -J1A)

Sanitary Fitting, Maxi Flange 1-1/2" to 600 Series Barb, 1.0" (25.4 mm) Tubing ID

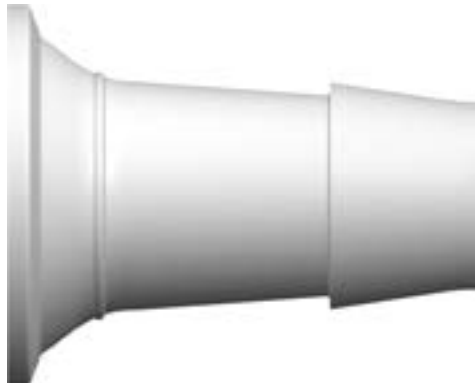

SFMX680 (-6005 -J1A)

Sanitary Fitting, Maxi Flange 1-1/2" to 600 Series Barb, 1/2" (12.7 mm) Tubing ID



SFMXC (-6005 -J1A)

Sanitary Fitting Maxi Cap 1-1/2"



BIOPROCESS FITTINGS

- 001 (various, see part description)
- 06 Orange Nylon
- 07 Yellow Nylon
- 0 Natural Nylon
- 1 White Nylon
- 2 Black Nylon
- 3 Red Nylon
- 4 Green Nylon
- 5 Blue Nylon
- 7 Glass Filled Natural Nylon
- 8 Gray Nylon
- 8B Gray Nylon
- 9 Clear Polycarbonate
- 10 Acetal
- 40 Polysulfone
- 81 Lace White ABS
- 91 White Polycarbonate
- 1006 Natural Acetal
- 1007 Black Acetal
- 6005 Animal-Free Polypropylene
- 6006 White Polypropylene
- 8003 Natural ABS
- 8012 White ABS
- 9002 Rad. Stable Polycarbonate
- 9010 Rad. Stable Polycarbonate
- B Buna-N O-ring
- CM030 Dark Blue Nylon
- E PTEE/EPDM
- EP EPDM O-ring
- J1A Natural Kynar PVDF
- J1A2 Black Kynar PVDF
- PX Platinum-Cured Silicone
- U71 White Class VI Glass Filled Nylon
- U75 Blue Class VI Glass Filled Nylon
- VP1 Animal-free Polyethylene
- X2 Buna-N Rubber
- XO Stainless Steel

Need samples for evaluation?

You can call to request most of our standard product in quantities of 5, or less, for free application evaluation.
+1 (970) 267-5200 Toll Free: (888) 404-5837

Need it fast?

You can order any of our 4,000+ parts online now with no order \$ minimums, 24 hours a day, 7 days a week!
www.valueplastics.com

Resin Reference

- Pg 82** Chemical Resistance
- Pg 83** Regulatory Status
- Pg 84** Sterilization Stability
- Pg 85** Typical Properties