

Material Suffix Key

-001 Radiation Stable Polycarbonate
 -4 Green Nylon
 -6 Natural Polypropylene
 -9 Clear Polycarbonate

-1 White Nylon
 -5 Blue Nylon
 -6005 Animal-Free Polypropylene
 -9002 Radiation Stable Polycarbonate

-2 Black Nylon
 -06 Orange Nylon
 -8003 Natural ABS
 -9010 Radiation Stable Polycarbonate

-3 Red Nylon
 -07 Yellow Nylon
 -8012 White ABS
 -J1A Natural Kynar PVDF

FTLC (-1 -6 -9 -9002 -J1A)

Female Luer Lug Style Coupler

LC34 (-1 -6 -9 -9002 -J1A)

Male Luer Integral Lock Ring to Female Luer Thread Style Coupler

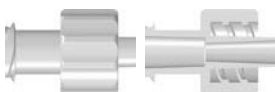
LC78 (-1 -6 -9 -9002 -J1A)

Male Luer to Female Luer Thread Style Coupler *(May be used with separate rotating lock ring; FSLLR)*

LT878 (-1 -6 -9 -9002)

Female Luer Thread Style (2) to Male Luer Tee *(May be used with separate rotating lock ring; FSLLR)*

LT787 (-1 -6 -9 -8012 -9002)

Male Luer (2) to Female Luer Thread Style Tee *(May be used with separate rotating lock ring; FSLLR)*

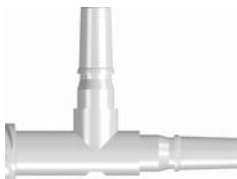
FTLT (-1 -6 -9 -J1A)

Female Luer Lug Style Tee

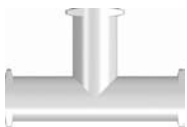
FTLLE (-1 -6 -9 -J1A)

Female Luer Thread Style Elbow

FTLE (-1 -6 -9 -J1A)

Female Luer Lug Style Elbow

LE87 (-1 -6 -8003 -9 -9002)

Male Luer to Female Luer Thread Style Elbow *(May be used with separate rotating lock ring; FSLLR)*

LE7220 (-1 -2)

Male Luer to 200 Series Barb Elbow, 3/32" (2.4 mm) ID Tubing *(May be used with separate rotating lock ring; FSLLR)*

LE7230 (-1 -6 -9 -9010)

Male Luer to 200 Series Barb Elbow 1/8" (3.2 mm) ID Tubing *(May be used with separate rotating lock ring; FSLLR)*

CA091 (-001)

Male Luer Elbow to 3/16" Classic Series Barb, (CF361-9002) with Rotating Lock Ring (FSLLR-9002)

