

Material Suffix Key

-1 White Nylon
-9002 Radiation Stable Polycarbonate

-6 Natural Polypropylene

-8012 White ABS

-9 Clear Polycarbonate

MLB035 (-1 -8012 -9)

Male Large Bore Non-Luer Connector to 500 Series Barb, 3/16" (4.8 mm) ID Tubing

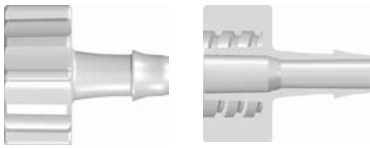

FLB035 (-1 -8012 -9)

Female Large Bore Non-Luer Connector to 500 Series Barb, 3/16" (4.8 mm) ID Tubing

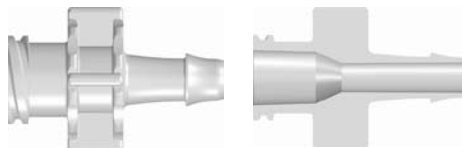

MLB055 (-1 -8012 -9)

Male Large Bore Non-Luer Connector to 500 Series Barb, 1/4" (6.4 mm) ID Tubing

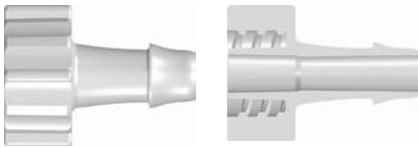

FLB055 (-1 -8012 -9)

Female Large Bore Non-Luer Connector to 500 Series Barb, 1/4" (6.4 mm) ID Tubing

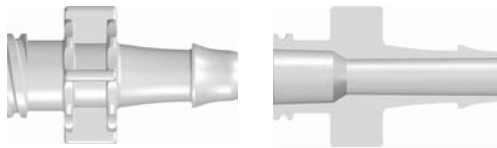

MLB065 (-1 -8012 -9)

Male Large Bore Non-Luer Connector to 500 Series Barb, 5/16" (8.0 mm) ID Tubing

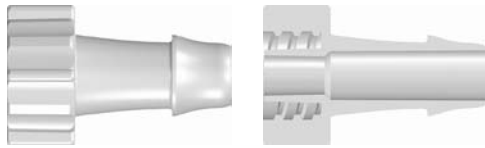

FLB065 (-1 -8012 -9)

Female Large Bore Non-Luer Connector to 500 Series Barb, 5/16" (8.0 mm) ID Tubing

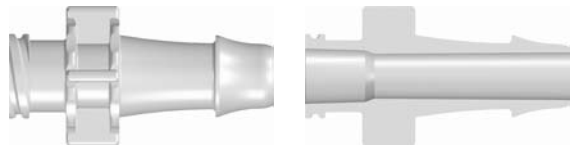

MLBC7 (-9002)

Male Large Bore Non-Luer Connector with Integral Lock Ring to Male Slip Luer (May be Used with Separate Rotating Lock Ring; FSLLR)

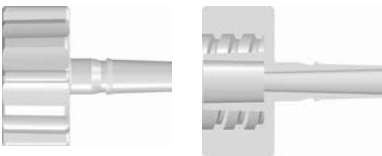

**LARGE BORE CONNECTORS:
Plugs and Caps**

FLBP (-1 -8012 -9)

Female Large Bore Non-Luer Cap



MLBC8 (-9002)

Male Large Bore Non-Luer Connector with Integral Lock Ring to Female Thread-Style Locking Luer

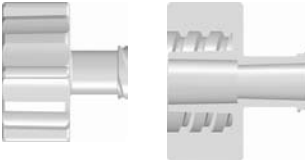

MLBP (-1 -8012 -9 -9002)

Male Large Bore Non-Luer Plug



our online ordering for component parts, now available 24 hours a day, 7 days a week, with no \$ minimums! You can find every catalog part at:

www.valueplastics.com

(Online ordering is not available in countries served by our regional partners)

Website : www.chromtech.net.au E-mail : info@chromtech.net.au TelNo : 03 9762 2034 . . . in AUSTRALIA

500 piece minimums • ■ Red Text = Special order items • Volume pricing may be available for quantities 5,000 and over • Call for details!