



LUER TO THREAD:

Female

SFTL	NUMBER	MATERIAL
 <p>Female Luer Lug Style with 5/16" Hex to 1/4-28 UNF Thread</p>	SFTL-1	White Nylon
	SFTL-6	Natural Polypropylene
	SFTL-9	Clear Polycarbonate
	SFTL-J1A	Natural Kynar PVDF

18FTLL	NUMBER	MATERIAL
 <p>Female Luer Thread Style with 7/16" Hex to 1/8-27 NPT Thread</p>	18FTLL-1	White Nylon
	18FTLL-6	Natural Polypropylene
	18FTLL-J1A	Natural Kynar PVDF

18LFTLL	NUMBER	MATERIAL
 <p>Female Luer Thread Style Elbow with 7/16" Hex to 1/8-27 NPT Thread</p>	18LFTLL-1	White Nylon
	18LFTLL-4	Green Nylon
	18LFTLL-5	Blue Nylon
	18LFTLL-6	Natural Polypropylene
	18LFTLL-J1A	Natural Kynar PVDF
18LFTLL-62	Black Polypropylene	

PANEL MOUNTS:

Female Thread and Lug Style Luer

FTLLB210	NUMBER	MATERIAL
 <p>Female Luer Thread Style Panel Mount 1/4-28 UNF to 200 Series Barb, 1/16" (1.6 mm) ID Tubing</p>	FTLLB210-1	White Nylon
	FTLLB210-6	Natural Polypropylene
	FTLLB210-9	Clear Polycarbonate
	FTLLB210-J1A	Natural Kynar PVDF

FTLLB220	NUMBER	MATERIAL
 <p>Female Luer Thread Style Panel Mount 1/4-28 UNF to 200 Series Barb, 3/32" (2.4 mm) ID Tubing</p>	FTLLB220-1	White Nylon
	FTLLB220-2	Black Nylon
	FTLLB220-6	Natural Polypropylene
	FTLLB220-9	Clear Polycarbonate
	FTLLB220-J1A	Natural Kynar PVDF

FTLLB230	NUMBER	MATERIAL
 <p>Female Luer Thread Style Panel Mount 1/4-28 UNF to 200 Series Barb, 1/8" (3.2 mm) ID Tubing</p>	FTLLB230-1	White Nylon
	FTLLB230-2	Black Nylon
	FTLLB230-6	Natural Polypropylene
	FTLLB230-9	Clear Polycarbonate
	FTLLB230-J1A	Natural Kynar PVDF

PANEL MOUNTS:

Female Lug Style, Thread and Male Luer

FTLB210	NUMBER	MATERIAL
 <p>Female Luer Lug Style Panel Mount 1/4-28 UNF to 200 Series Barb, 1/16" (1.6 mm) ID Tubing</p>	FTLB210-1	White Nylon
	FTLB210-6	Natural Polypropylene
	FTLB210-9	Clear Polycarbonate
	FTLB210-J1A	Natural Kynar PVDF

FTLB220	NUMBER	MATERIAL
 <p>Female Luer Lug Style Panel Mount 1/4-28 UNF to 200 Series Barb, 3/32" (2.4 mm) ID Tubing</p>	FTLB220-1	White Nylon
	FTLB220-6	Natural Polypropylene
	FTLB220-9	Clear Polycarbonate
	FTLB220-J1A	Natural Kynar PVDF

FTLB230	NUMBER	MATERIAL
 <p>Female Luer Lug Style Panel Mount 1/4-28 UNF to 200 Series Barb, 1/8" (3.2 mm) ID Tubing</p>	FTLB230-1	White Nylon
	FTLB230-6	Natural Polypropylene
	FTLB230-9	Clear Polycarbonate
	FTLB230-J1A	Natural Kynar PVDF

FTLLBMLRL	NUMBER	MATERIAL
 <p>Female Luer Thread Style Panel Mount 1/4-28 UNF to Male Luer (May be used with separate rotating lock ring; FSLLR)</p>	FTLLBMLRL-1	White Nylon
	FTLLBMLRL-6	Natural Polypropylene

MLRLB210	NUMBER	MATERIAL
 <p>Male Luer Panel Mount 10-32 UNF to 200 Series Barb, 1/16" (1.6 mm) ID Tubing, (May be used with separate rotating lock ring; FSLLR)</p>	MLRLB210-1	White Nylon
	MLRLB210-6	Natural Polypropylene

MLRLB220	NUMBER	MATERIAL
 <p>Male Luer Panel Mount 10-32 UNF to 200 Series Barb, 3/32" (2.4 mm) ID Tubing, (May be used with separate rotating lock ring; FSLLR)</p>	MLRLB220-1	White Nylon
	MLRLB220-6	Natural Polypropylene

MLRLB230	NUMBER	MATERIAL
 <p>Male Luer Panel Mount 1/4-28 UNF to 200 Series Barb, 1/8" (3.2 mm) ID Tubing, (May be used with separate rotating lock ring; FSLLR)</p>	MLRLB230-1	White Nylon
	MLRLB230-6	Natural Polypropylene

CCR	NUMBER	MATERIAL
Color Coded Ring (For use with PMS, PMK, FTLB or FTLB panel mount fittings)	CCR-1	White Nylon
	CCR-2	Black Nylon
	CCR-3	Red Nylon
	CCR-4	Green Nylon
	CCR-5	Blue Nylon
	CCR-06	Orange Nylon
	CCR-07	Yellow Nylon



CCLR	NUMBER	MATERIAL
Color Coded Lock Ring (For use with PMS, PMK, FTLB or FTLB panel mount fittings)	CCLR-1	White Nylon
	CCLR-2	Black Nylon
	CCLR-3	Red Nylon
	CCLR-4	Green Nylon
	CCLR-5	Blue Nylon
	CCLR-06	Orange Nylon
	CCLR-07	Yellow Nylon



PMKN	NUMBER	MATERIAL
Panel Mount Nut 10-32 UNF with 3/8" Hex (For use with PMK panel mount fittings)	PMKN-XO	Stainless Steel



PMSN	NUMBER	MATERIAL
Panel Mount Nut 1/4-28 UNF with 7/16" Hex (For use with PMS, FTLB, and FTLB panel mount fittings)	PMSN-XO	Stainless Steel



LNS	NUMBER	MATERIAL
1/4-28 UNF Panel Mount Lock Nut (For use with PMS, FTLB or FTLB panel mount fittings)	LNS-1	White Nylon
	LNS-2	Black Nylon
	LNS-3	Red Nylon
	LNS-4	Green Nylon
	LNS-5	Blue Nylon
	LNS-06	Orange Nylon
	LNS-07	Yellow Nylon
	LNS-11A	Natural Kynar PVDF

SELECT THE CORRECT LOCK NUT FOR YOUR PANEL MOUNT:

PART	Dimension A	Use Lock Nut
FTLLB Series	.255"	PMSN or LNS
FTLB Series	.255"	PMSN or LNS
FTLLBMLRL	.255"	PMSN or LNS
MLRLB-210	.193"	PMKN
MLRLB-220	.193"	PMKN
MLRLB-230	.255	PMSN or LNS

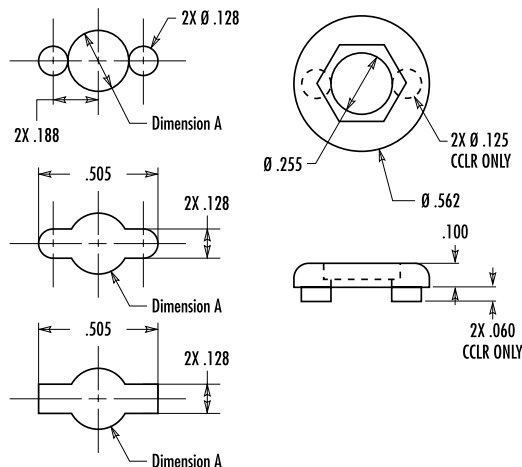

our online ordering arriving Fall 2006 for North America only, 24 hours a day, 7 days a week, with increased ordering flexibility! You can find every catalog part at www.valueplastics.com

CF104	NUMBER	MATERIAL
Male Luer Integral Lock Ring Plug, Ø.033 Orifice at Luer Tip	CF104-6	Natural Polypropylene



CF226	NUMBER	MATERIAL
High Flow Connector to 500 Series Barb, 1/4" (6.4 mm) ID Tubing (May be used with separate rotating lock ring; CF227)	CF226-6	Natural Polypropylene



CF304	NUMBER	MATERIAL
High Flow Connector Body with 500 Series Barb, 3/8" (9.5 mm) ID Tubing	CF304-6	Natural Polypropylene



CF015	NUMBER	MATERIAL
Female Luer Lug Style Flare to M6x.75 Thread	CF015-1	White Nylon



CF131	NUMBER	MATERIAL
Male Luer Integral Lock Ring Plug, Closed at Grip (Short Luer)	CF131-1	White Nylon



CF141	NUMBER	MATERIAL
Male Luer to Female Luer Thread Style Coupler (Ø.045 Thru Bore with Ø.055 Male Side Bond-in Port)	CF141-9	Clear Polycarbonate

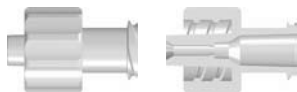

CF148	NUMBER	MATERIAL
Male Luer to Female Luer Thread Style Coupler (Ø.045 Thru Bore with Ø.080 Male Side Bond-in Port)	CF148-9002	Rad. Stable Polycarbonate

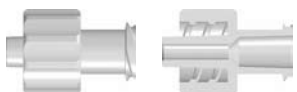

CF184	NUMBER	MATERIAL
Female Luer To Catheter Handle	CF184-1	White Nylon



CF210	NUMBER	MATERIAL
Male Luer to Female Luer Thread Style Coupler (Ø.125 Center Bond-in Port)	CF210-6	Natural Polypropylene

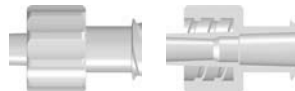

CF213	NUMBER	MATERIAL
Male Luer Integral Lock Ring Plug, Closed at Grip (Ø.055 to Ø.060 Core)	CF213-3	Red Nylon



CF224	NUMBER	MATERIAL
Male Luer Integral Lock Ring to 500 Series Barb, 5/32" (4 mm) ID Tubing (Ø.076 Bore)	CF224-9	Clear Polycarbonate



CF233	NUMBER	MATERIAL
Female Extended Luer Thread Style to 200 Series Barb, 1/16" (1.6 mm) ID Tubing	CF233-6	Natural Polypropylene



CF235	NUMBER	MATERIAL
Male Luer to Female Luer Thread Style Coupler (Ø.023 Thru Bore with Ø.033 Male Side Bond-in Port)	CF235-3	Red Nylon
	CF235-9	Clear Polycarbonate
	CF235-91	White Polycarbonate

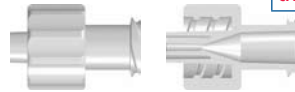

CF239	NUMBER	MATERIAL
Male Luer Integral Lock Ring to Female Luer Thread Style Extended Coupler	CF239-6	Natural Polypropylene



CF322	NUMBER	MATERIAL
Female Luer Lug Style Flare to 1/4-32 UNF Thread	CF322-1	White Nylon



HRMalytic www.chromtech.net.au sales@chromtech.net.au
 AEN 14 643 445 058 **PTY LTD** Tel: (03) 9762 2034 Fax: +61 3 9761 1169
TECH nology
 Australian Distributors: ... for ALL your chromatography supplies!